

Turin Smart City:
how a philanthropic
foundation can contribute
to European net zero

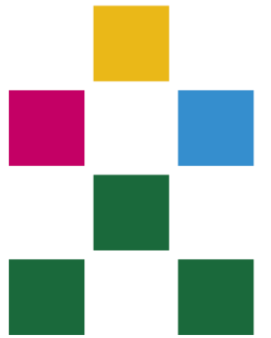

Fondazione
Compagnia
di San Paolo

Alberto Anfossi –
Segretario Generale di
Fondazione Compagnia
di San Paolo

Doing strategic philanthropy in the times of change

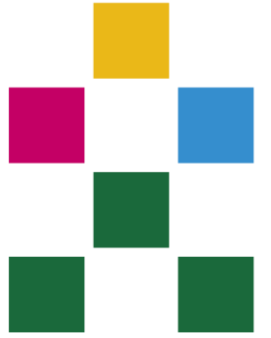

Most of the relevant European foundations are typically rooted at the local level - being able to act as local antennas - and have long-standing track records of funding programs, processes, and projects in the social, environmental, research and innovation fields.

Foundations have the potential to partner with civil society organizations, local communities, cities and regions to achieve the goals set by the Commission for the “100 Cities Mission”.

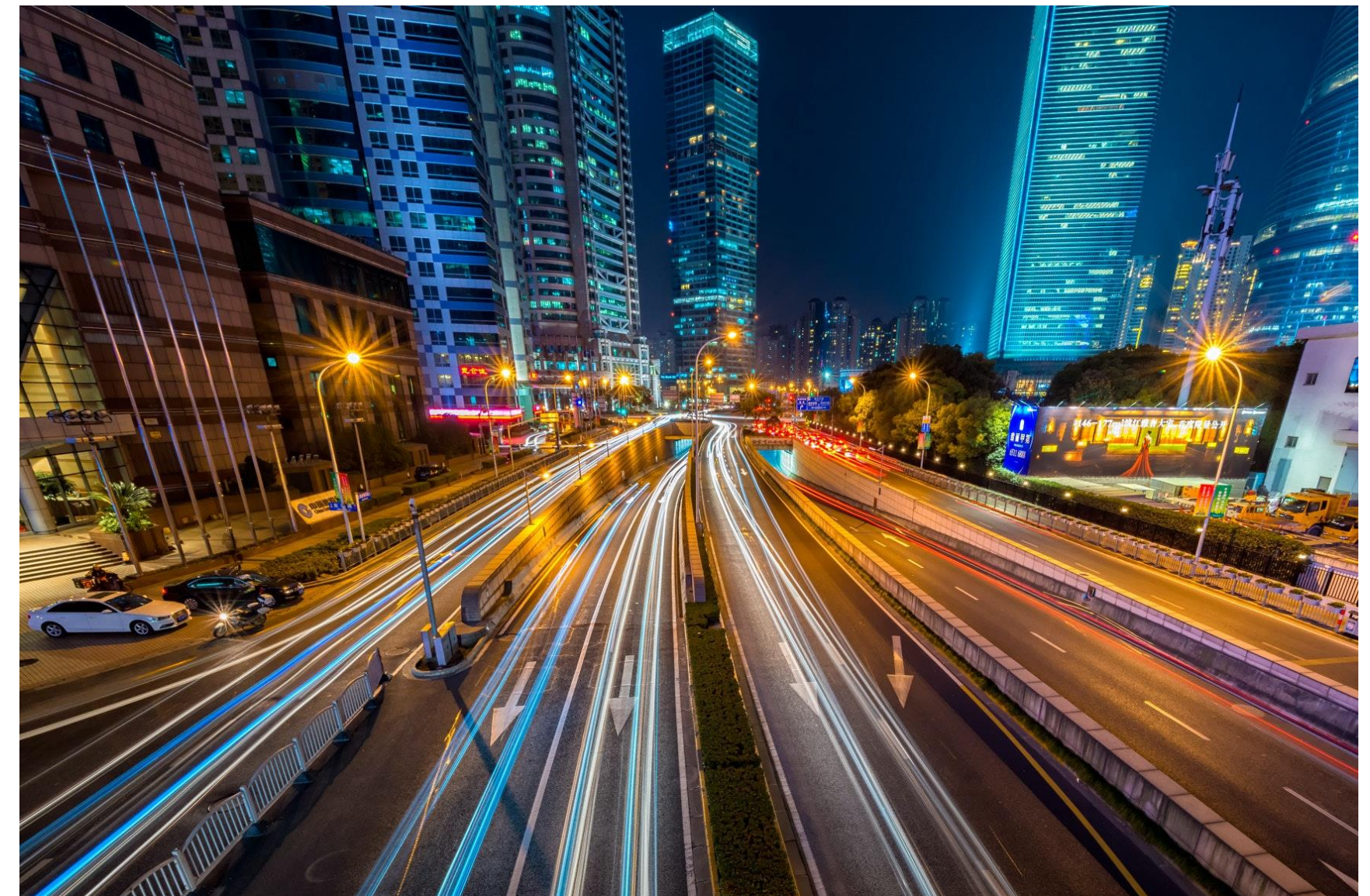

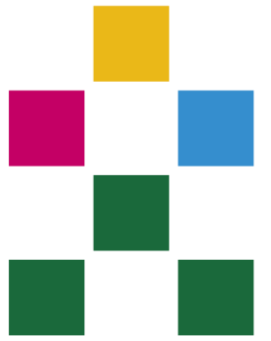

First valley of death: foundations can provide capabilities and competences

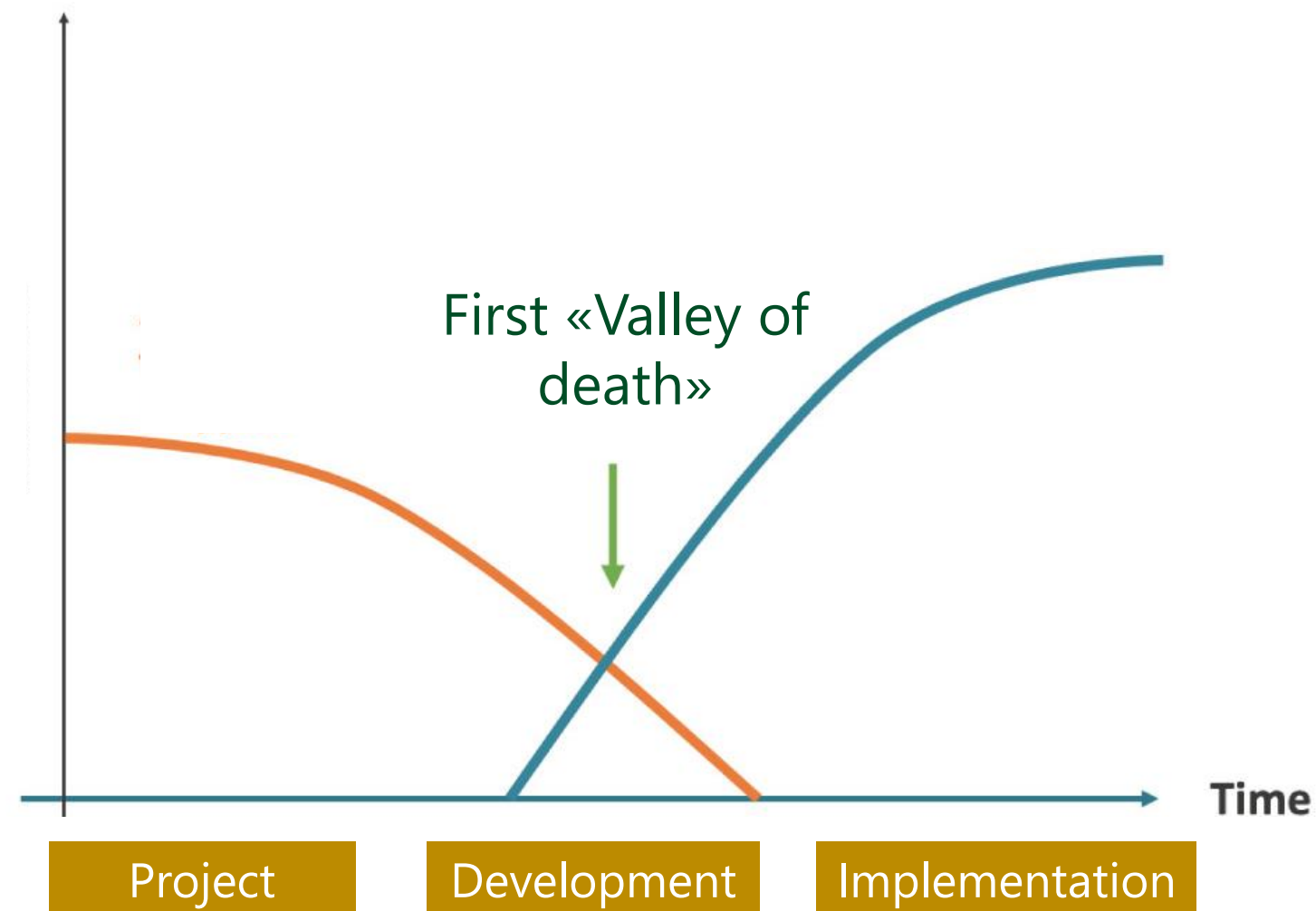

The first valley consists in the gap, due to a lack of competences, from setting an objective (eg. setting up a city digital twin; reorganizing the municipal transport/energy/waste management system) to organize it into a well-defined and effective set of fundable and feasible projects, able to deliver the expected results.

Foundations can support cities (granting or paying for) in getting access to additional experts from the project design (engineers, legals, ...) down to project management and reporting.

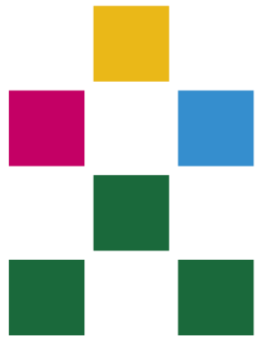

Second valley of death: foundations can activate the world of finance

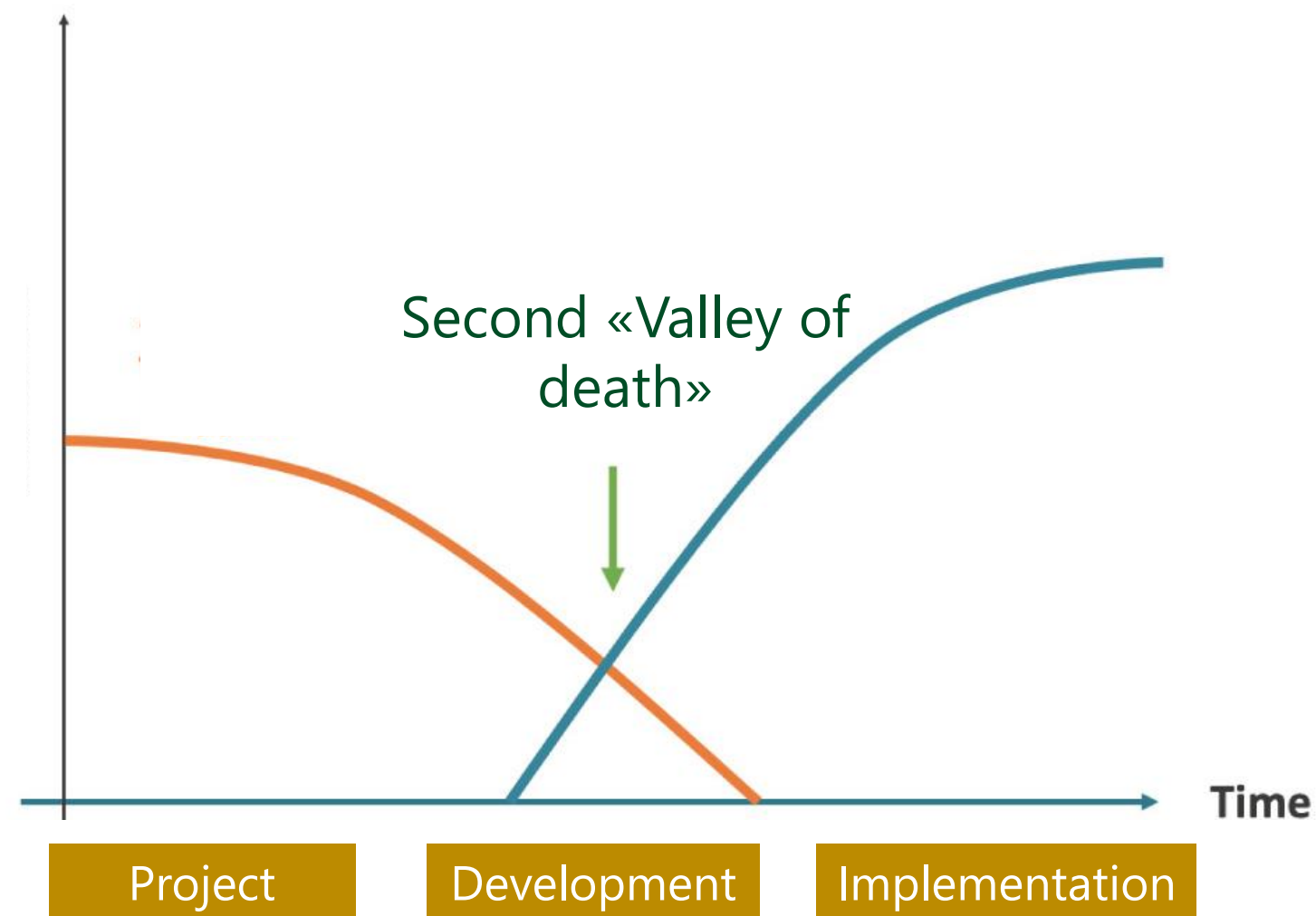

The second valley is related to the opportunity of identifying possible sources of private funding for a project, making it interesting/feasible for an investor (e.g. an institutional investor) or a company to (co)finance it.

Foundations can activate finance practitioners and/or community of investors working in PPP or blended schemes.

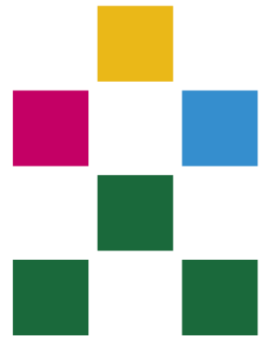

The Compagnia di San Paolo case: a successful scalable pilot

Since 2021 Compagnia di San Paolo (CSP) set up the "[Next Generation WE](#)" call, with the goal of enabling a **tailor-made support to cities** located in the north-west of Italy **to successfully apply to PNRR calls, attract the money and deliver the project effectively**:

1. economical support up to € 80.000 to acquire/contractualize external professionals;
2. access to competences;
3. once the project proposal is successfully funded by PNRR, training, courses, coaching to internal resources (cities' employees) for the execution phase of the projects.



Competenze, strategie, sviluppo
delle Pubbliche Amministrazioni.

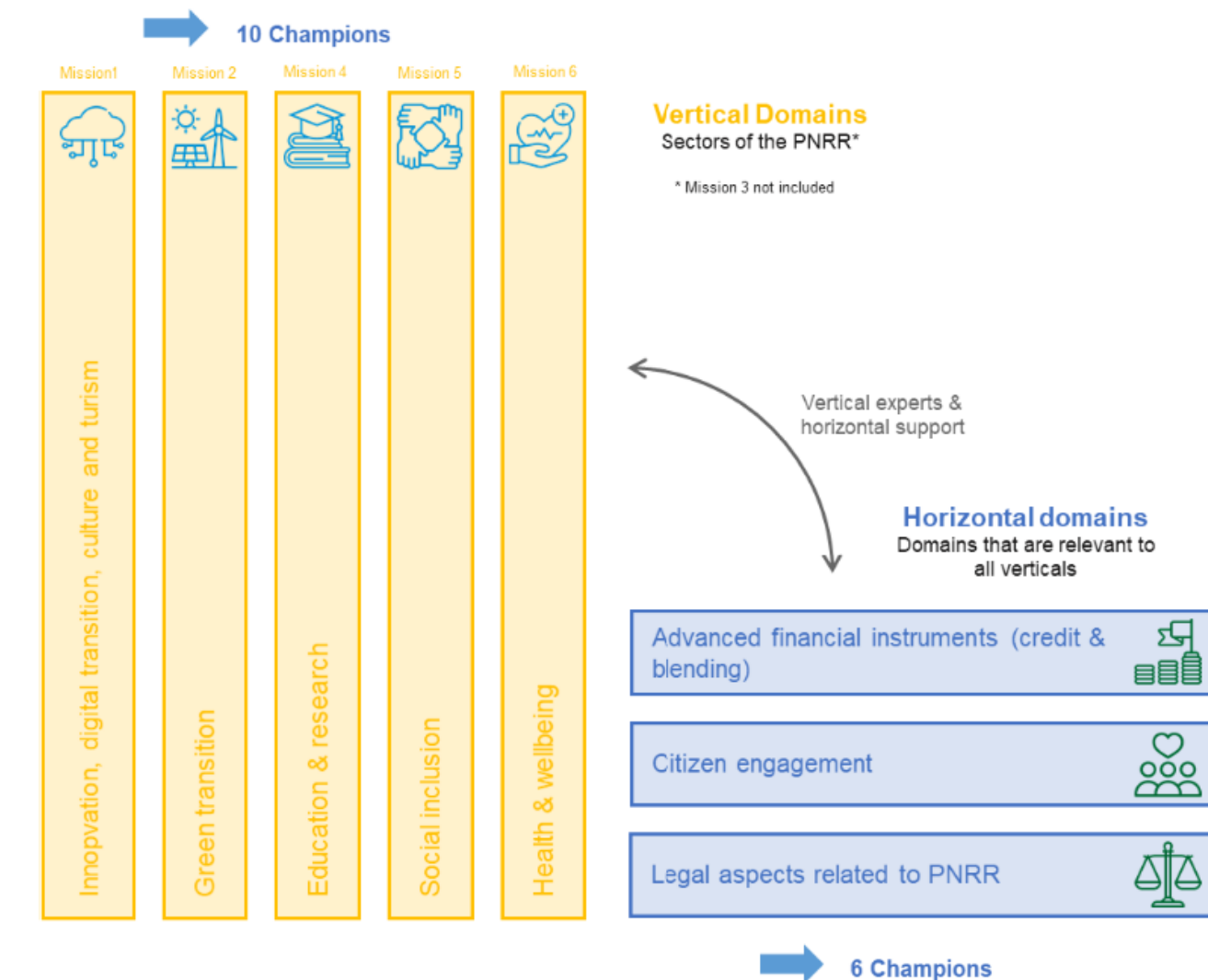

Further examples and suggestions

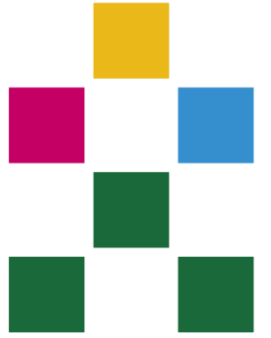

Most of the relevant European philanthropic foundations and most of the national networks of foundations, are members of [Philea - Philanthropy Europe Association](#).

If we compare the EU map where the 100 cities are located with Philea's members location, we find significant superpositions.

Potential activities:

1. Systematically **gather and provide examples** of effective calls/programs/activities relevant to the 100 Cities Mission;
2. Raise awareness among members and possibly set up a specific **cluster of foundations** interested in partnering with some of the 100 selected cities.

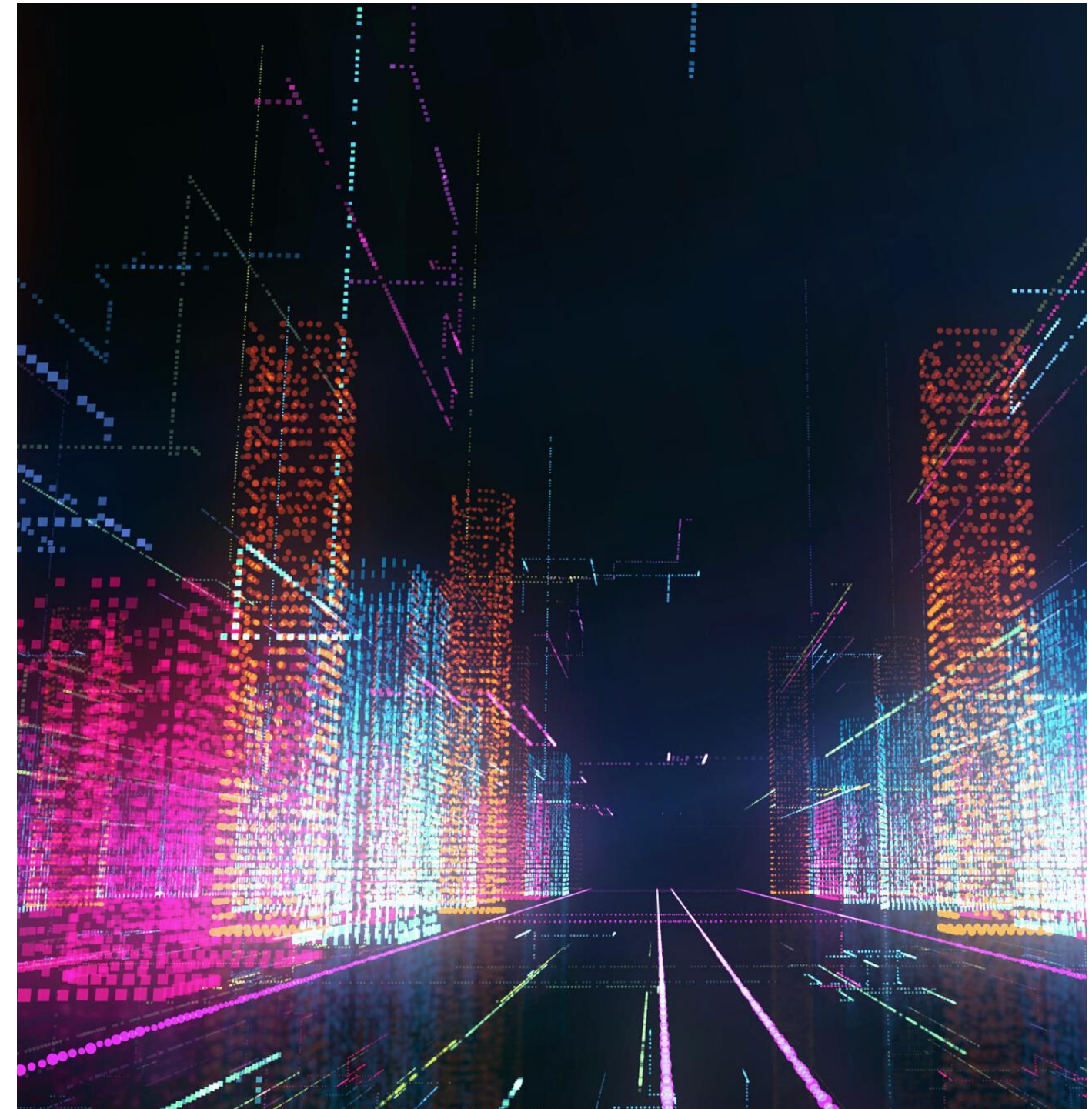

Obiettivo Pianeta - Sustainability Competence Center

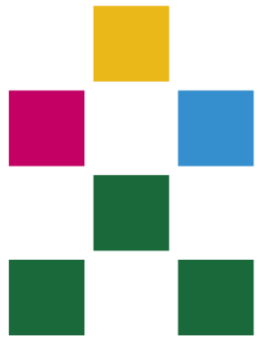

Main Missions:

- Protecting the environment.
- Promoting well-being
- Opening international perspective
- Accelerating innovation
- Boosting research

Integrated Approach:

- Sustainability as human and environmental well-being (**One Health approach**).



Initiatives for Sustainability and Innovation

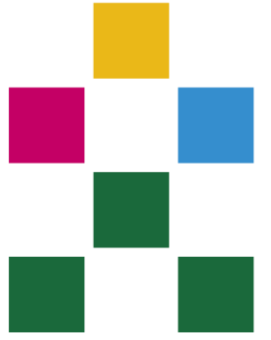

Key Projects:

- **TEAM Mobilità Futura:** zero-emission public transport.
- **Renewable Energy Communities (CER):** expanding civic engagement and energy sustainability.
- **Techstarts Turin:** accelerator for startups in urban innovation.
- **Next Generation We:** support for ecological transition under the NRRP (National Recovery and Resilience Plan).
- **Simbiosi** and **BRAS** (Bando Restauro Ambientale Sostenibile) for ecosystem regeneration
- **Oasi Pianeta** project for pollinator protection



SIMBIOSI
Insieme alla natura per il futuro del Pianeta.



Towards a Turin Smart City

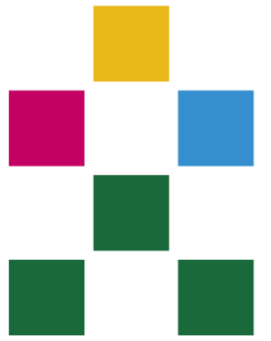

Urban Transformation Goals:

- Building an **inclusive, sustainable, and technologically advanced city.**
- **Promoting involvement** from citizens, businesses, and institutions..

Long-Term Vision:

- Positioning **Turin** as a **model** of **European** and global **excellence** in sustainability.
- **Improving quality of life** and reducing environmental impact.



The Cavallerizza Reale Project

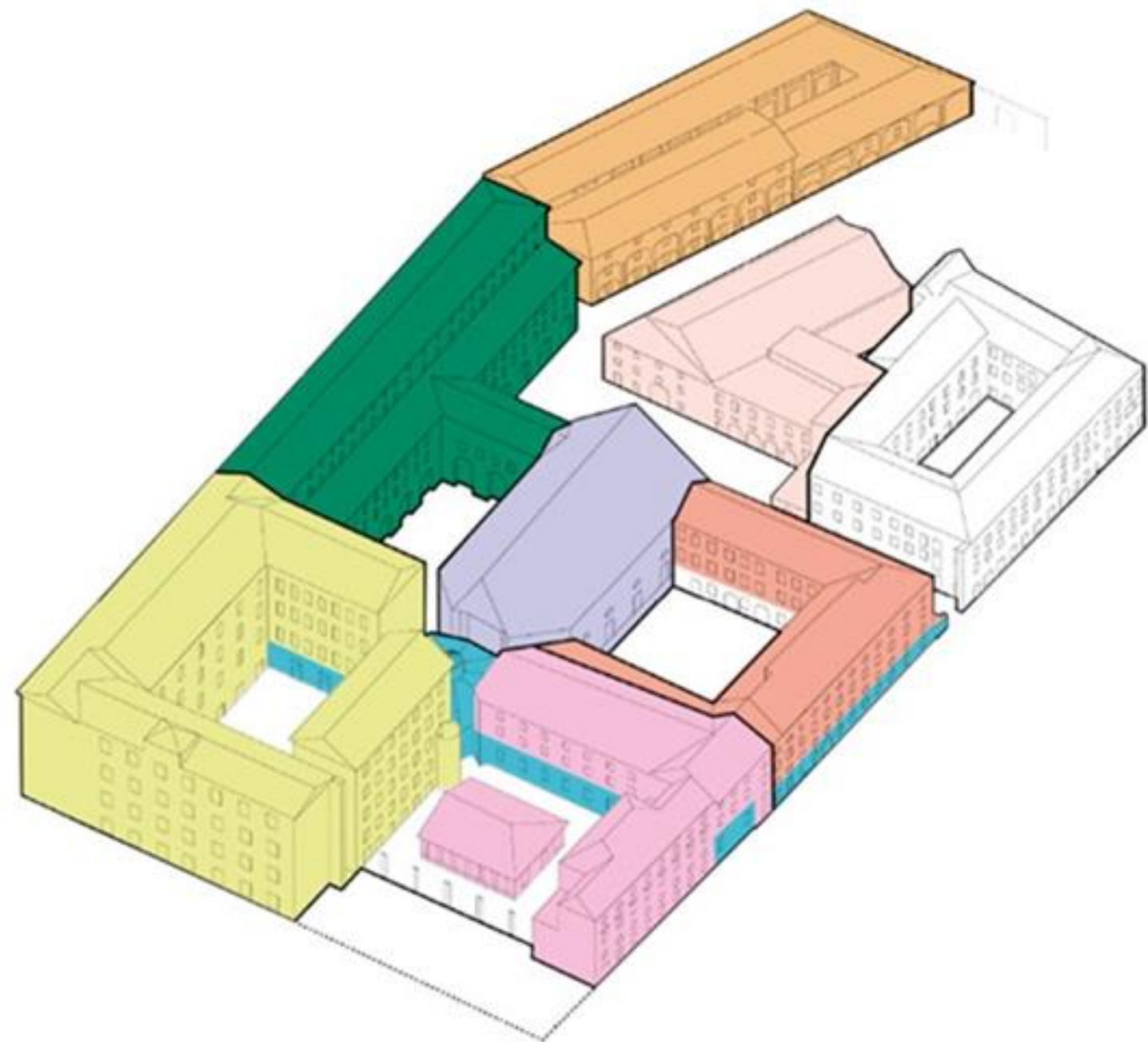
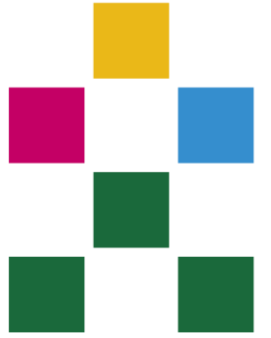

17th-century Savoy complex, UNESCO heritage site.

Project Goals:

- Urban regeneration and sustainability.
- Creating an international cultural space.

Sustainable Approach:

- "Open site" model to engage the community.
- Use of geothermal systems and smart grid integration.



The Cavallerizza Reale Project



The Geothermal Plant for Cavallerizza Reale

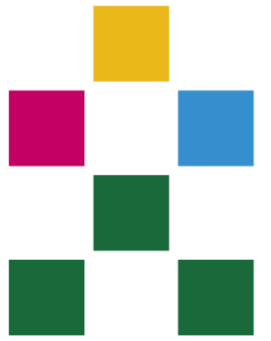

Goals:

- Reducing environmental impact.
- Preserving the architectural integrity of the complex.

Technical Features:

- Centralized system for heating and cooling.
- Smart grid connection for energy optimization.

Partnership:

- Iren Smart Solution for technology integration.

Winter

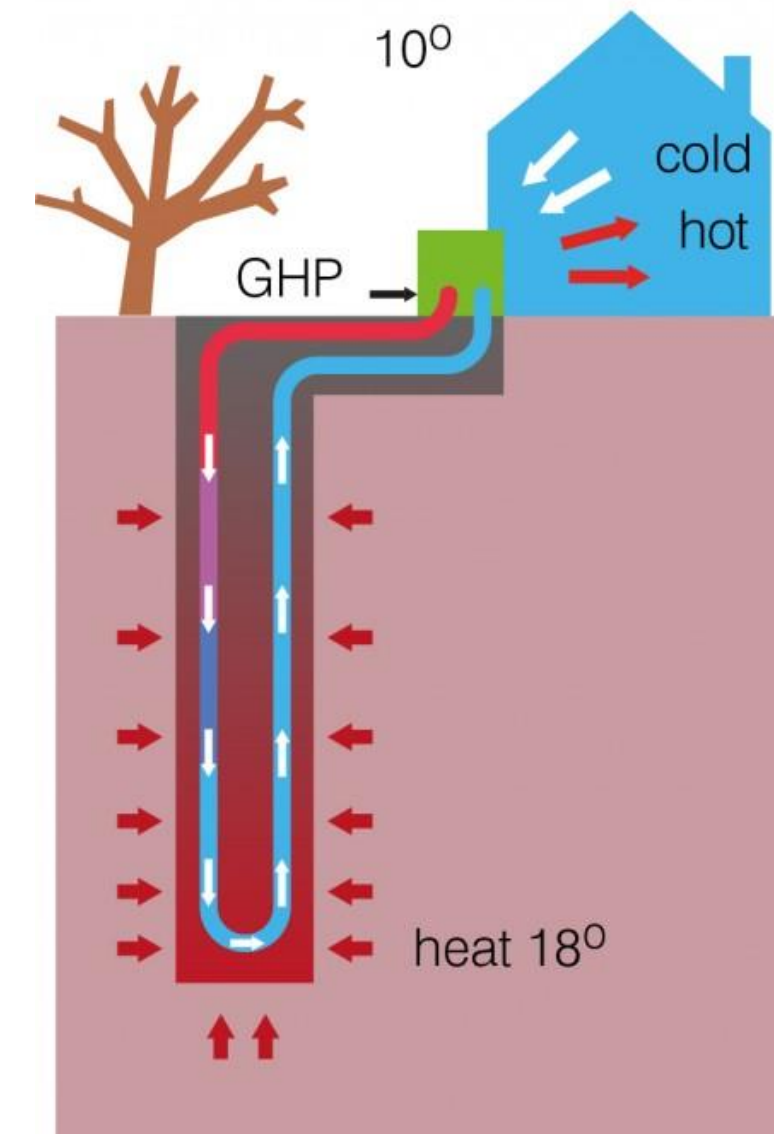

Summer

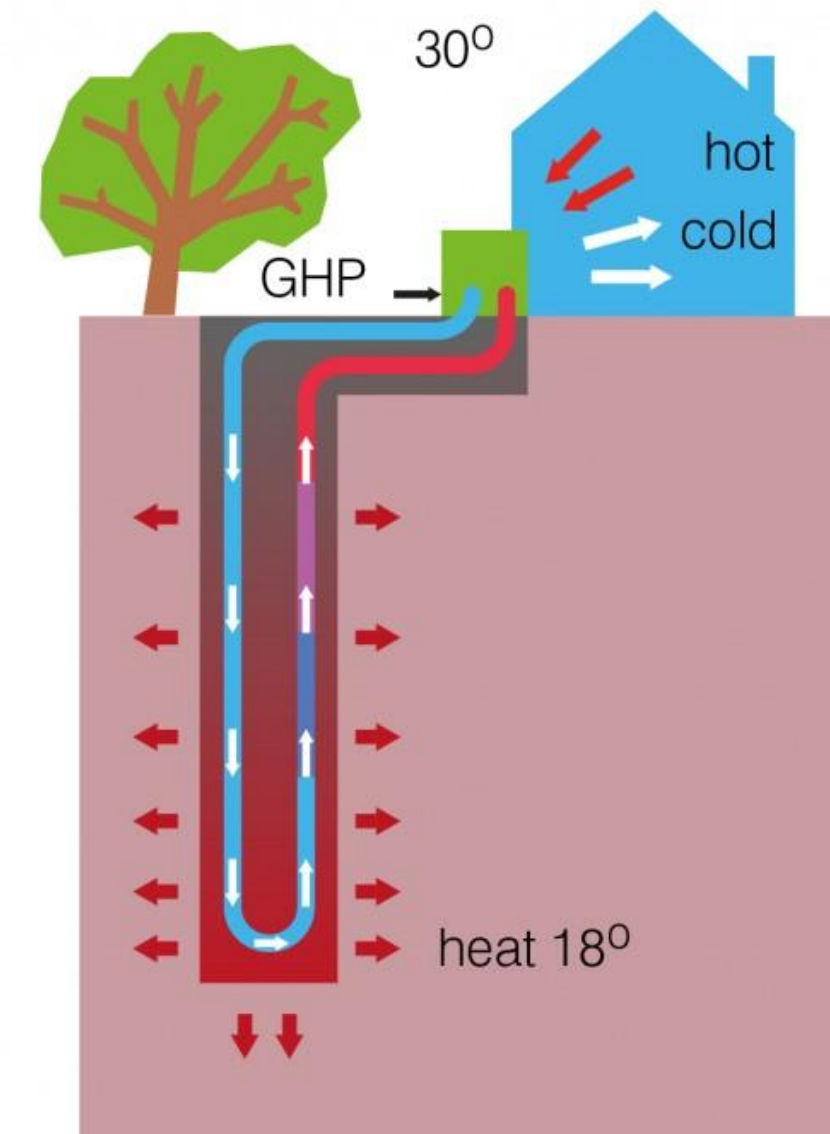

Lot 0: Geothermal at district level

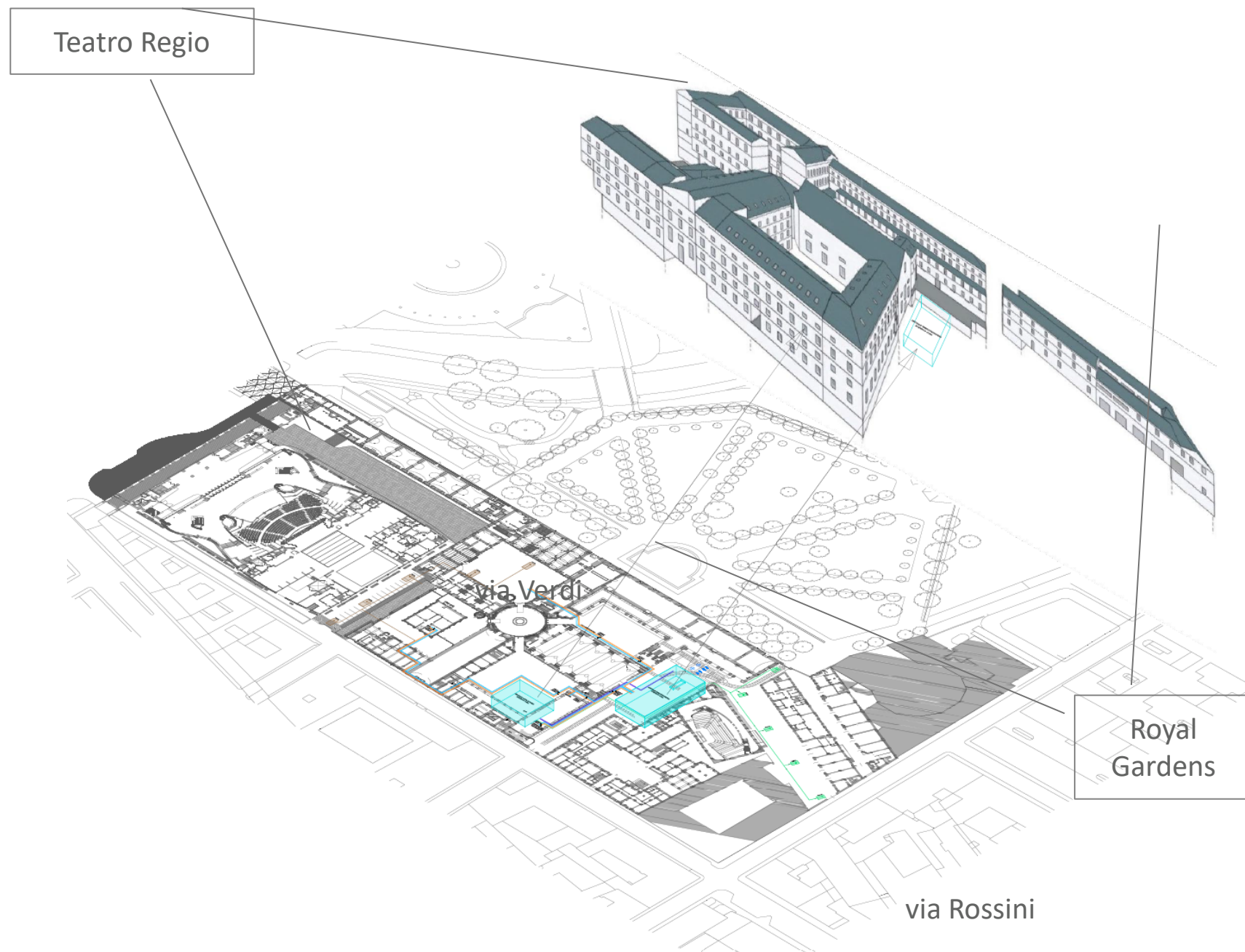

- A **common strategy** to all the properties
- Creation of **energy production** and **distribution systems** on a "**neighborhood**" scale, based on **renewable** sources (**geothermal**)

The plant concept involves the **construction** of a **centralized system** for the production of energy from **geothermal sources**, intended for **heating** and **air conditioning** of the rooms.

The strategy involves the use of **groundwater** present in the **subsoil** as a **thermal source** from which to **take heat in winter** and **release it in summer** through exchange with **water-to-water heat pumps**.
Once the heat exchange is complete, all the **water pumped** from the subsoil will be **reintroduced** into the **aquifer**.

With the construction of a **common ring**, the **necessary fluids** for the air conditioning of the rooms will be **conveyed** to the **individual blocks** of the building.

Lot 0: systems and backups - building context



Underground area (-5.00m)
- THERMO-REFRIGERATION UNIT
- ELECTRICAL SUBSTATION AND CONTROL ROOM

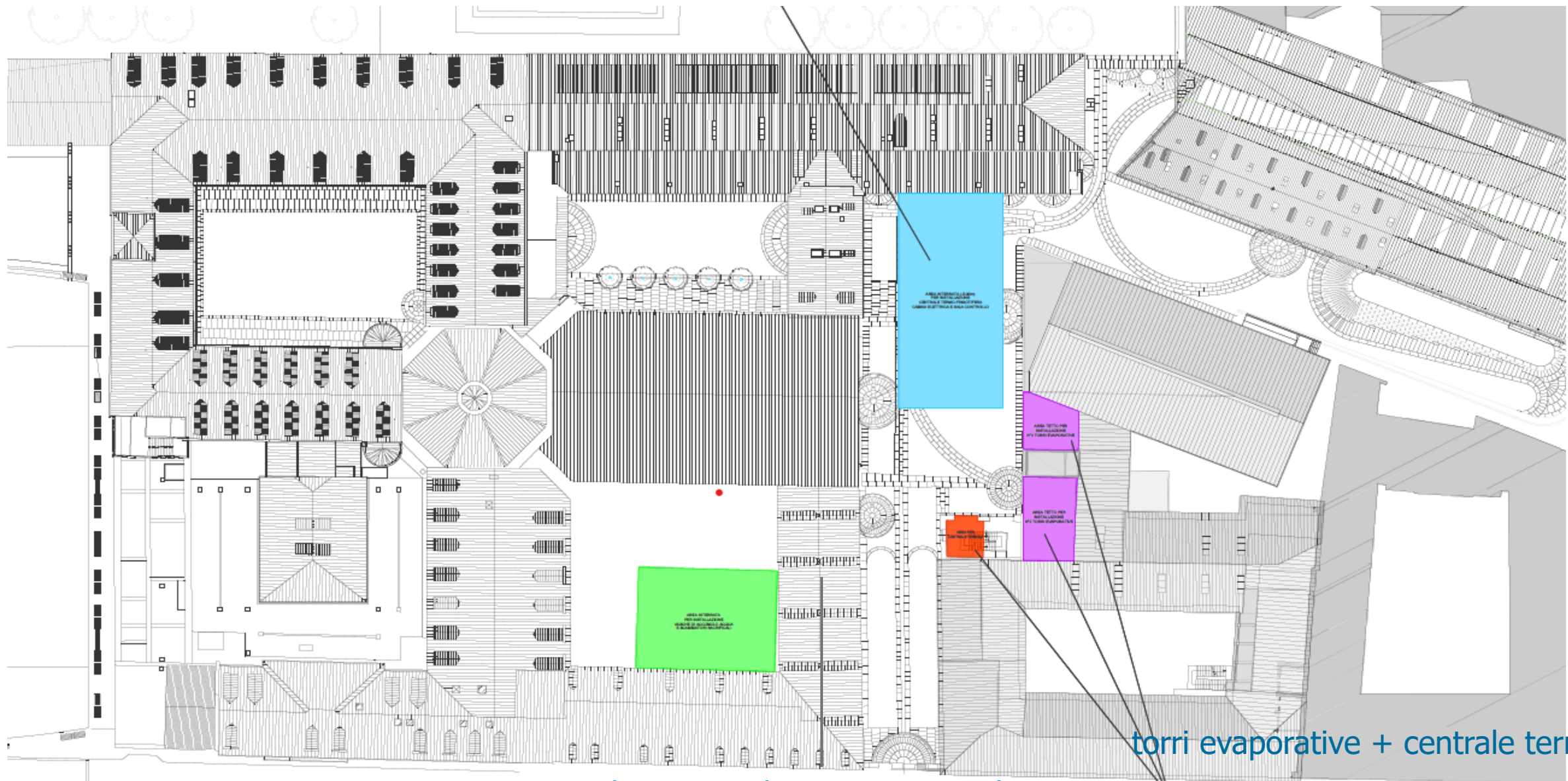

torri evaporative + centrale termica

vasche accumulo acqua + scambiatori

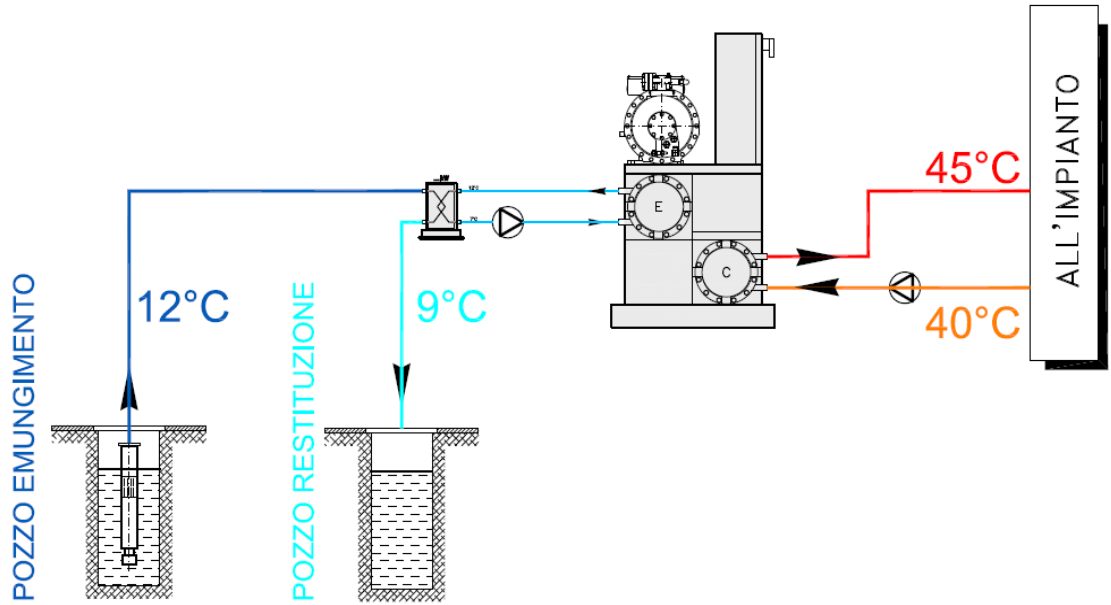

Sustainability certifications and protected properties

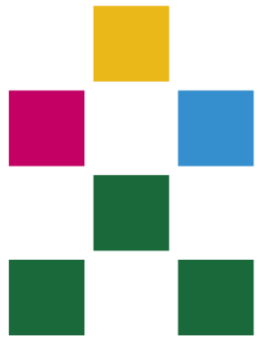

PROTOCOLLI DI SOSTENIBILITÀ AMBIENTALE

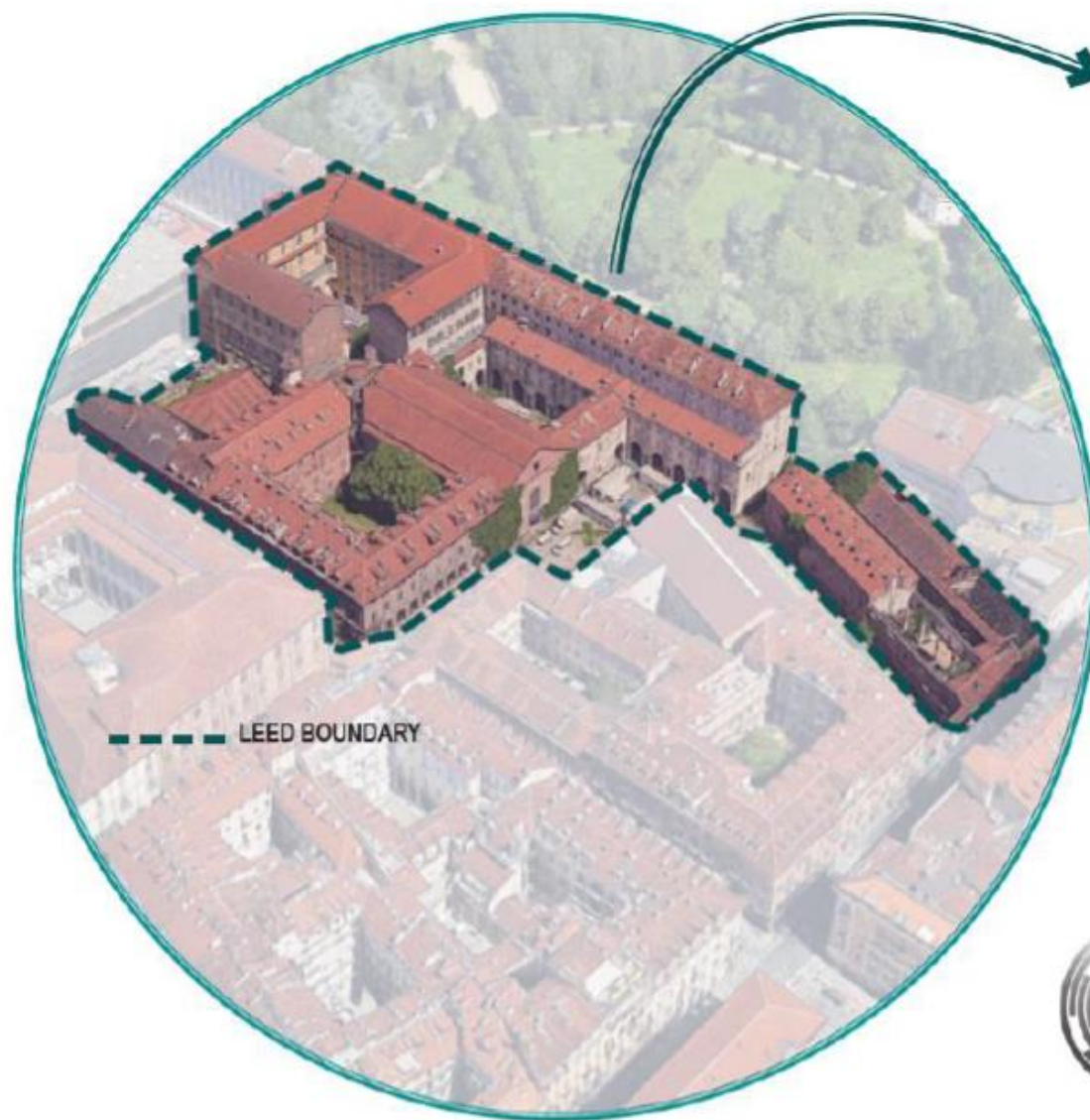

The **GBC Historic Building Protocol** is a sustainability certification framework designed specifically for **historic and monumental buildings** built **before 1954** and with at least the **50% of existing technical elements intact**.

Developed by the Green Building Council (**GBC**), this protocol aims to balance the need to **preserve the historical integrity** of these structures with the **promotion of sustainable construction and management practices**.

Historic buildings present unique challenges when it comes to sustainability, as their cultural, architectural and historical requires a **delicate** and **careful approach**.

Key aspect: **energy efficiency, resource management, occupant health and well-being, cultural heritage conservation, sensitivity** to the **surrounding environment** and **positive social impact**.

THE 1ST SMART CITIES, TOWNS, RURAL AND MOUNTAIN VILLAGES INTERNATIONAL CONGRESS



SCIENTIFIC PARTNERS



COMMUNICATION PARTNER



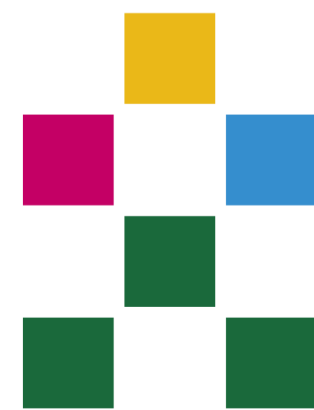

Fondazione
Compagnia
di San Paolo